

COPPERLINE CONDOMINIUMS

Opening the door to waterfront living

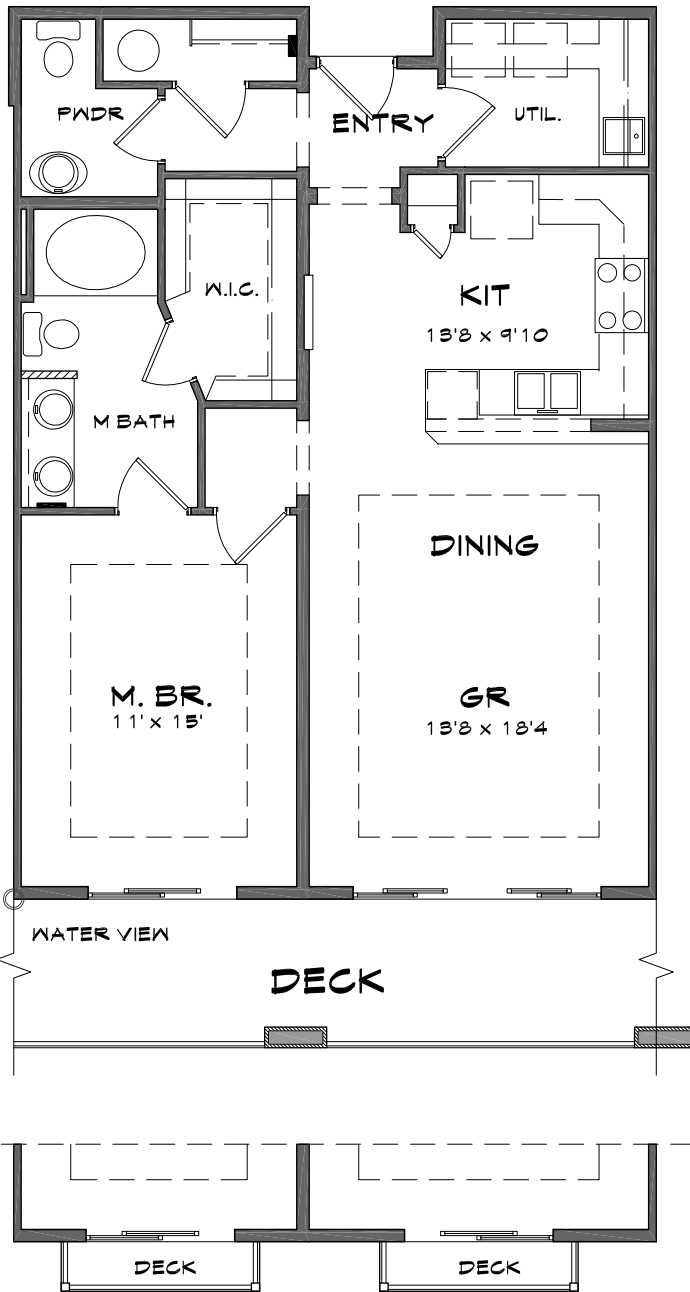

STEVENS FLOOR PLAN

BUILDING A

1 Bedroom, 1.5 Bath

874 SF of Living Space

28 -817 SF of Patio/Deck
(size varies by unit)

902 – 1,691 Total SF

Base Price:
\$405,950 – \$470,950

The following units in Building A
feature the Stevens floor plan:

Village Side - 408-A, 414-A, 508-A,
514-A, 608-A, 616-A, 708-A, 714-A,
808-A, 814-A

Water Side - 407-A, 415-A, 507-A, 515-A,
607-A, 615-A, 707-A, 715-A

*Prices subject to change.
All measurements are approximate.*

VILLAGE VIEW

- * 4TH thru 7TH LEVEL CEIL. HT @ 9'.
- * 8th LEVEL CEIL. HT @ 10' UNLESS NOTED OTHERWISE



For additional information, please contact our Community Sales Manager,
Jessica Volkman at 253.759.8400 or jessica@pointruston.com